

# D-080 COMBINATION AIR VALVE WITH SHUT-OFF VALVE

A combination air valve (kinetic & automatic) that includes a shut-off valve as an integral part of valve's body.

## Maximum fitness for underground chamber

Minimum height and width dimensions.

Upper operational access to shut-off valve. Optional operation by extended-shaft from without the chamber.

NRS valve (Non Raise Stem) Fixed height of shut-off valve.

When the shut-off valve is closed, the complete internal mechanism can be removed easily upward as a separate assembly, allowing for easy maintenance.

Automatic air release up to 450 m<sup>3</sup>/h. Saves energy and reduces operation costs.

Three Independent Automatic Air release valve working according to A.R.I patented rolling seal principal.

Dramatically reduces the possibility of obstruction by debris.

The Automatic units are implanted inside the kinetic float and are protected from outward damage.

An inner "air pillow" protects the valve against damage from freezing.

Dynamic design allows high velocity air discharge, Preventing premature closing.

Maximum rate: 80mm - up to 3,400 M<sup>3</sup>h 100mm - up to 4,500 M<sup>3</sup>h

"Anti-Slam" shutting as a consequence of "air pillow" inside valve's body that acts as a buffer.

Standard cast iron body - baked polyester coating.

Working pressure range: 0.2-16 bar. (3-230 psi).

Available in 3" (80mm), 4" (100mm) Flanges are available in BS/ISO/ANSI standards.



## Options:

- Screen outlet.
- Drainage outlet.

## KINETIC AIR DISCHARGE CHARTS

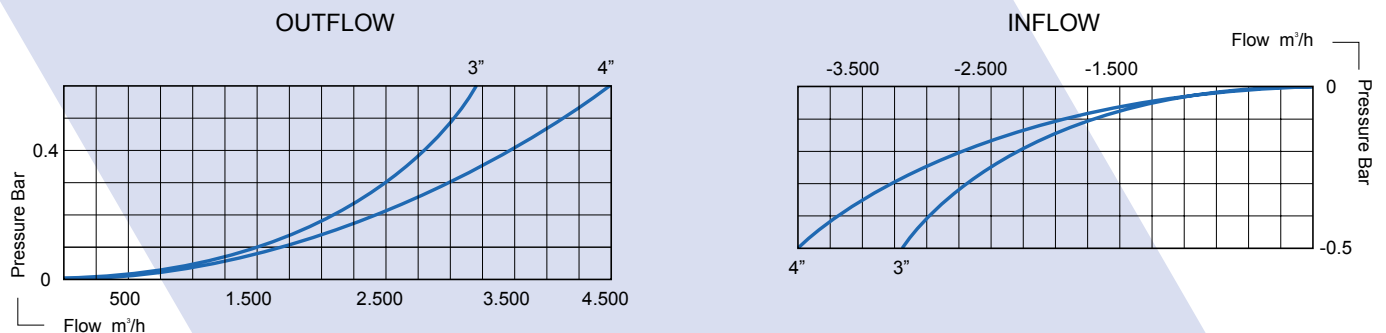

Auckland NZ  
PH: (09) 919 7600  
FAX: (09) 919 7604

Distributed by: **aquaspec**  
www.aquaspec.co.nz 0800 353 966

Christchurch NZ  
PH: (03) 968 3230  
FAX: (03) 968 3231

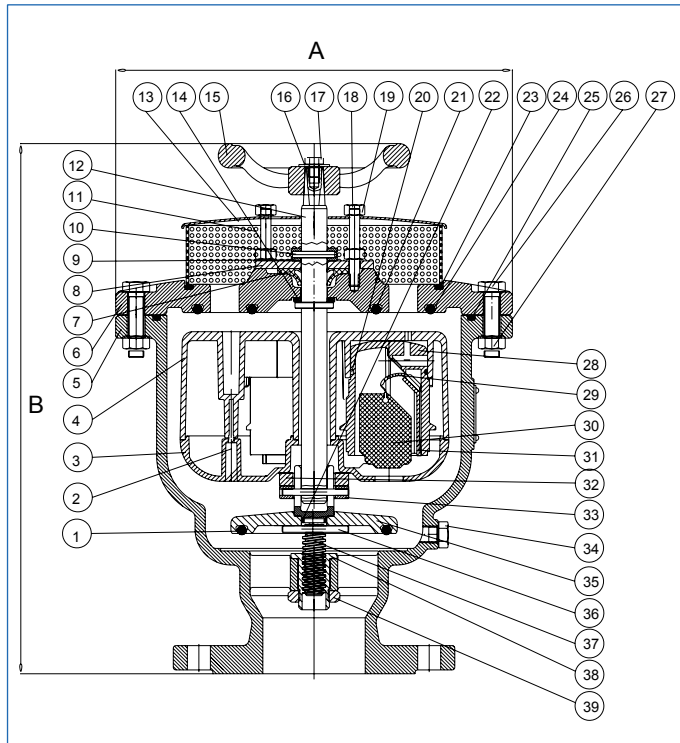

## PARTS LIST AND SPECIFICATION

No.	Part	Material
1.	O-Ring	BUNA-N
2.	Bolt	Stainless Steel
3.	Float (Down Part)	Reinforced Nylon
4.	Float (Upper Part)	Reinforced Nylon
5.	Body	Cast Iron ASTM A48 CL.35B
6.	Cover	Cast Iron ASTM A48 CL.35B
7.	Seal	Natural & Synthetic Rubber
8.	Seal Cover	Steel DIN ST.37
9.	Lock Washer	Stainless Steel SAE 303
10.	Lock Pin	Stainless Steel SAE 303
11.	Filter	Stainless Steel SAE 304
12.	Shaft	Stainless Steel SAE 303
13.	Filter Cover	Steel DIN ST.37
14.	Washer	Akulon (Ertlon)
15.	Wheel for Oblique valve	Alluminium
16.	Washer	Stainless Steel SAE 303
17.	Bolt	Stainless Steel SAE 303
18.	Cover Bolt	Galvanized Steel Chromate Plated
19.	Cover Nut	Galvanized Steel Chromate Plated
20.	Segev O-Ring	BUNA-N
21.	Cover O-Ring	BUNA-N
22.	Spindle O-Ring	BUNA-N
23.	Cover O-Ring	BUNA-N
24.	Cover O-Ring	BUNA-N
25.	Body O-Ring	BUNA-N
26.	Body Bolt	Galvanized Steel Chromate Plated
27.	Body Nut	Galvanized Steel Chromate Plated
28.	Segev Body	Reinforced Nylon
29.	Segev Rolling Seal	E.P.D.M.
30.	Segev Float	Polypropylene
31.	Segev Clamping Stem	Reinforced Nylon
32.	Height Washer	Acetal
33.	Lock Washer	Acetal
34.	Stopper	Bras ASTM B-124
35.	Disk	Cast Bronze
36.	Pin	Stainless Steel SAE 303
37.	Spindle	Stainless Steel SAE 303
38.	Spindle Bushing	Bronze
39.	Spindle Nut	Bronze

## AUTOMATIC AIR DISCHARGE CHART

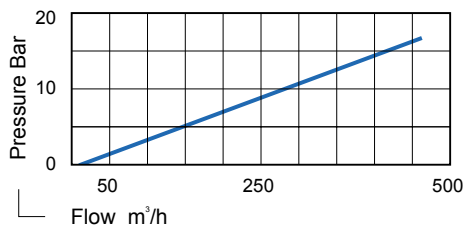

## DIMENSIONS AND WEIGHTS

Nominal Size	A	A with protective cover	B	Weight Kg (+Screen) (+P Cover)		Orifice Area mm <sup>2</sup>	
80mm 3"	310	445	414	36	38	Automatic	36
100mm 4"	310	445	414	37	39	Kinetic	7850



Auckland NZ  
PH: (09) 919 7600  
FAX: (09) 919 7604

Distributed by: **aquaspec**  
www.aquaspec.co.nz 0800 353 966

Christchurch NZ  
PH: (03) 968 3230  
FAX: (03) 968 3231